

LOAD REQUIREMENTS	
DISTRIBUTED LATERAL LOAD	25 kN/m <sup>2</sup>
TOP SLAB DISTRIBUTED LOAD	60 kN/m <sup>2</sup>
TOP SLAB POINT LOAD	70 kN

\* DISTRIBUTED AND POINT LOADS ON TOP SLAB SHALL NOT BE APPLIED SIMULTANEOUSLY.

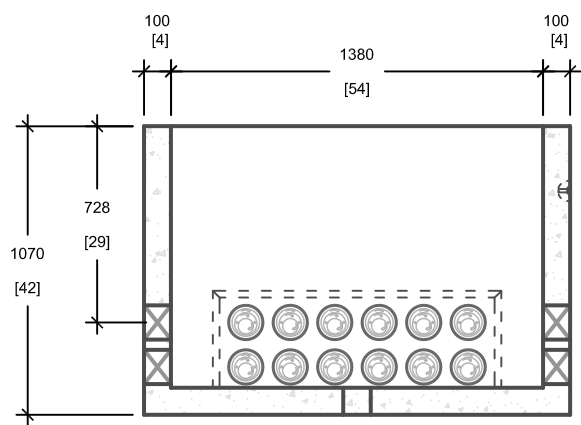

**CROSS SECTION 'B'**

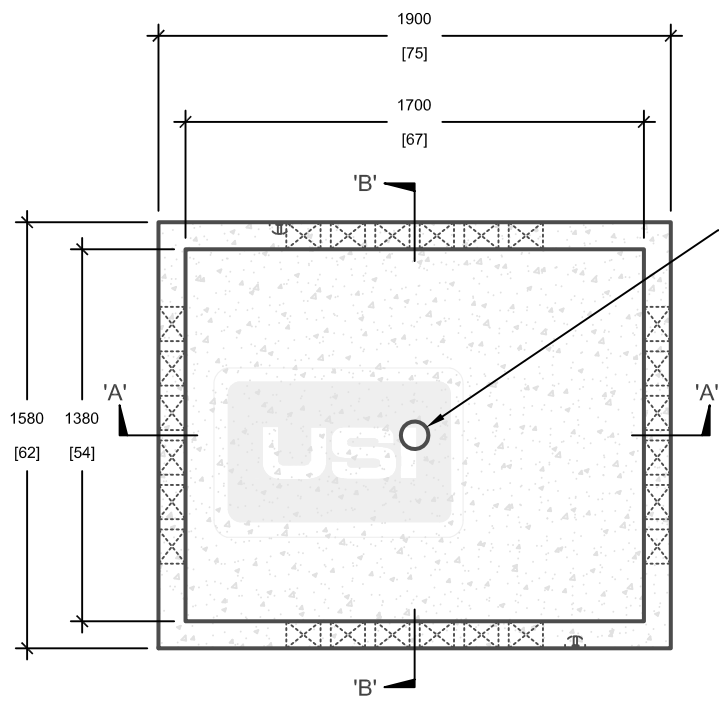

**PLAN VIEW**

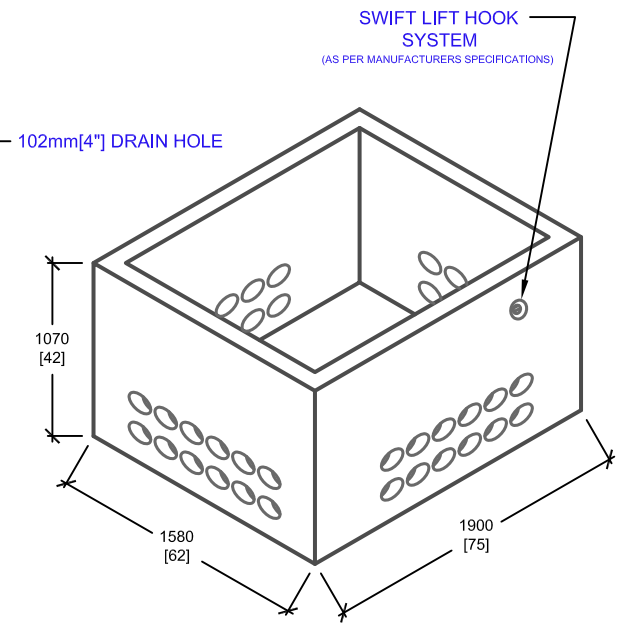

**ISOMETRIC VIEW**

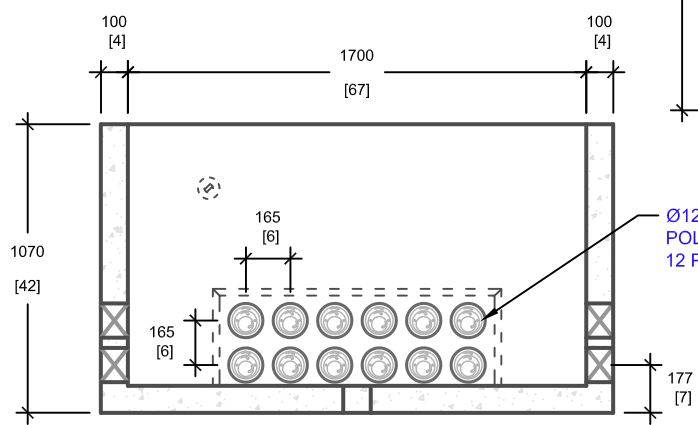

**CROSS SECTION 'A'**

Ø127mm [5] (TYP.)  
POLYLOK PIPESEAL  
12 PER SIDE

**NOTES:**  
 \* SOIL BEARING CAPACITY TO BE MIN. 130 kPa (SLS); VERIFY ON SITE.  
 \* THESE DRAWINGS ARE ONLY FOR STRUCTURAL. OTHER MATERS INCLUDING GEOTECHNICAL AND DRAINAGE TO BE TAKEN CARE BY THE ENGINEERS OF THE RESPECTIVE DISCIPLINES  
 \* TRANSFORMER ANCHORAGE TO E-14B-ONT BASE THROUGH E-14 (403) PAD FOR LATERAL LOADS (SEISMIC/WIND) BY OTHERS.

mm  
[Inches]  
ALL DIMENSIONS DEFAULT TO MILLIMETRES



**UTILITY STRUCTURES INC.**  
 61 BONGARD AVE | OTTAWA, ON | K2E 6V2  
 T: 613.225.6398 F: 613.225.1681 TF: 800.267.6466  
[www.utilitystructures.com](http://www.utilitystructures.com)

**CONSTRUCTION DETAILS:**

- REFERENCE **HYDRO ONE DU-09-403**
- **CSA A23.1**
  - 35 MPa (5000psi) AT 28 DAYS
  - STRIPPING STRENGTH: MIN. 20 MPa(2900psi)
  - 5-8% AIR ENTRAINED
  - EXPOSURE CLASS: C-1
- REINFORCING: STEEL TO CSA G30.18

**PRODUCT DETAILS:**

- (4) 127mm[5"] POLYLOK PIPESEAL WINDOWS (12 POLYLOKS PER WINDOW)
- THREE PHASE PAD-MOUNTEDSWITCHGEAR (4 WAY) TRANSFORMER BASE
- OPEN BOTTOM VERSION AVAILABLE (DWG# **E-14-ONT**)
- USE WITH **E-14 (403)** TRANSFORMER PAD
- **CUSTOM OPTIONS AVAILABLE:**
  - CUSTOM WINDOWS & OPENINGS

<b>PRODUCT CODE:</b>	
<b>E-14B-ONT</b>	
CLOSED BOTTOM THREE PHASE TRANSFORMER BASE	
<b>OUTSIDE DIMENSIONS:</b>	
<b>1.07m(H) x 1580mm x 1900mm</b>	
<b>TOTAL WEIGHT:</b>	
<b>3,110 kg / 6,845 lbs</b>	
<b>REVISION DATE:</b>	<b>JUNE 14, 2019</b>
<b>REV. #</b>	<b>4</b>